

GEM BLAZE 9W

GEM BLAZE ROUND DOWNLIGHT

Indoor Luminaire

Product Code:

LGEMB01R09XC / LGEMB01R09XN / LGEMB01R09XW

9W - 510lm - 6500K - CRI>80 - Beam Angle - 60°

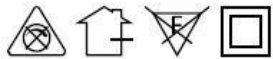

Technical Specifications

| | |
|------------------------------------|--|
| Operating Temperature | -10°C to 40°C |
| Rated Input Voltage & Frequency | 220 ~ 240 VAC, 50Hz |
| Rated Input Wattage | 9W ± 10% |
| Rated Input Current | 0.044 Amp (Nominal) |
| Power Factor | ≥0.90 |
| THD | <15% |
| Rated Luminous Flux | 510 lm / 480 lm / 450 lm (tolerance as per BIS) |
| Rated Luminaire Efficacy | 85 lm/W / 80 lm/W / 75 lm/W (tolerance as per BIS) |
| Correlated Color Temperature (CCT) | 6500 K / 4000 K / 3000 K (tolerance as per ANSI) |
| Color Rendering Index (CRI) | >80 |
| Beam Angle | 60° |
| Driver Efficiency | ≥80% |
| LED Life Span | >50000 Hrs (Ta=25°C @L70) |
| Housing | PC Housing |
| Lens / Reflector | PC Diffuser |
| Mounting | Recessed |

Protections

| | |
|-----------------------------------|-----------------------------------|
| Over Voltage Protection | Withstand upto 440V/AC for 4 Hrs. |
| Surge Protection | ±4.0KV |
| Protection Class | Class II |
| Ingress Protection (IP Rating) | IP20 |
| Impact Protection (IK Rating) | IK02 |
| Short Circuit Protection | Provided |
| Open Circuit Protection (No Load) | Provided |
| Reverse Polarity Protection | Provided |

Light Distribution

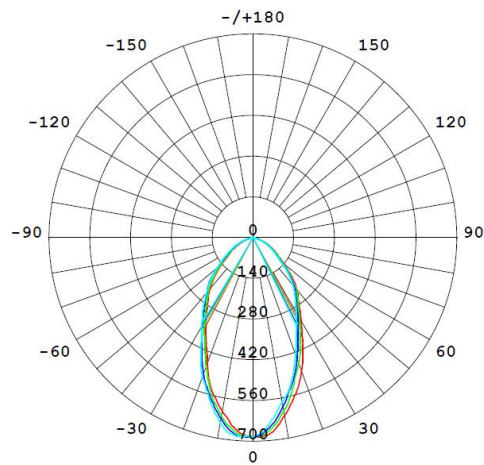

UGR Table

| | | | | | | | | | | | |
|---|-----|------------------|------|------|------|------|----------------|------|------|------|------|
| ceiling/cavity | | 0.7 | 0.7 | 0.5 | 0.5 | 0.3 | 0.7 | 0.7 | 0.5 | 0.5 | 0.3 |
| walls | | 0.5 | 0.3 | 0.5 | 0.3 | 0.3 | 0.5 | 0.3 | 0.5 | 0.3 | 0.3 |
| working plane | | 0.2 | 0.2 | 0.2 | 0.2 | 0.2 | 0.2 | 0.2 | 0.2 | 0.2 | 0.2 |
| Room dimensions | | Viewed crosswise | | | | | Viewed endwise | | | | |
| x = 2H y = 2H | 2H | 14.3 | 15.6 | 14.6 | 15.8 | 16.0 | 13.7 | 14.9 | 13.9 | 15.1 | 15.3 |
| | 3H | 15.1 | 16.2 | 15.3 | 16.4 | 16.6 | 14.1 | 15.2 | 14.3 | 15.4 | 15.7 |
| | 4H | 15.1 | 16.2 | 15.4 | 16.4 | 16.7 | 14.0 | 15.1 | 14.3 | 15.4 | 15.6 |
| | 6H | 15.1 | 16.1 | 15.4 | 16.4 | 16.6 | 14.0 | 15.0 | 14.3 | 15.3 | 15.5 |
| | 8H | 15.0 | 16.0 | 15.4 | 16.3 | 16.6 | 14.0 | 14.9 | 14.3 | 15.2 | 15.5 |
| | 12H | 15.0 | 16.0 | 15.3 | 16.2 | 16.5 | 13.9 | 14.9 | 14.2 | 15.1 | 15.4 |
| 4H | 2H | 14.6 | 15.7 | 14.9 | 15.9 | 16.1 | 14.0 | 15.1 | 14.3 | 15.3 | 15.6 |
| | 3H | 15.4 | 16.3 | 15.7 | 16.6 | 16.9 | 14.5 | 15.4 | 14.8 | 15.7 | 16.0 |
| | 4H | 15.5 | 16.3 | 15.8 | 16.6 | 17.0 | 14.5 | 15.3 | 14.8 | 15.6 | 16.0 |
| | 6H | 15.4 | 16.2 | 15.8 | 16.5 | 16.9 | 14.4 | 15.2 | 14.8 | 15.5 | 15.9 |
| | 8H | 15.4 | 16.1 | 15.8 | 16.5 | 16.9 | 14.4 | 15.1 | 14.8 | 15.5 | 15.8 |
| | 12H | 15.4 | 16.0 | 15.8 | 16.4 | 16.8 | 14.4 | 15.0 | 14.8 | 15.4 | 15.8 |
| 8H | 4H | 15.4 | 16.1 | 15.8 | 16.5 | 16.8 | 14.4 | 15.1 | 14.9 | 15.5 | 15.9 |
| | 6H | 15.4 | 16.0 | 15.8 | 16.4 | 16.8 | 14.4 | 15.0 | 14.9 | 15.4 | 15.8 |
| | 8H | 15.4 | 15.9 | 15.8 | 16.3 | 16.8 | 14.4 | 14.9 | 14.9 | 15.3 | 15.8 |
| | 12H | 15.4 | 15.8 | 15.9 | 16.3 | 16.7 | 14.4 | 14.8 | 14.9 | 15.3 | 15.7 |
| 12H | 4H | 15.4 | 16.0 | 15.8 | 16.4 | 16.8 | 14.4 | 15.0 | 14.8 | 15.4 | 15.8 |
| | 6H | 15.4 | 15.9 | 15.8 | 16.3 | 16.7 | 14.4 | 14.9 | 14.9 | 15.3 | 15.8 |
| | 8H | 15.4 | 15.8 | 15.8 | 16.2 | 16.7 | 14.4 | 14.8 | 14.9 | 15.3 | 15.7 |
| Variations with the observer position at spacings (CIE Pub.117) : | | | | | | | | | | | |
| S = 1.0H | | + 0.7 / - 0.9 | | | | | + 0.9 / - 1.0 | | | | |
| 1.5H | | + 0.5 / - 0.5 | | | | | + 0.4 / - 0.6 | | | | |
| 2.0H | | + 1.4 / - 1.0 | | | | | + 1.4 / - 1.0 | | | | |

Product Dimensions (DiaxH)

Ø 116 X 53mm (Tol. ± 5 mm), Cutout Size 87mm

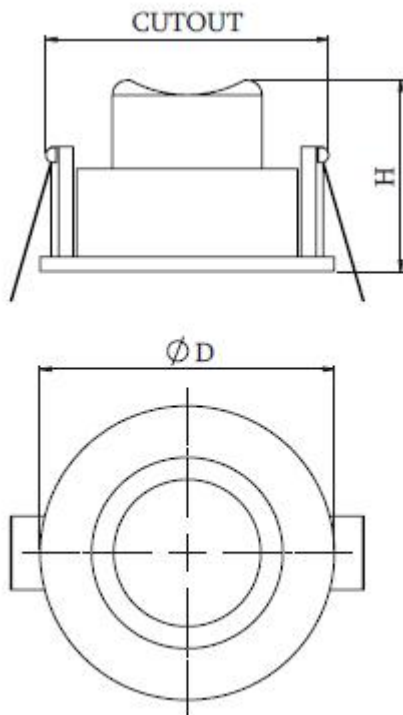

Applications

Residences, Offices, Small Retail Shops,
Hotels, Coffee Shops, Restaurants, Hospitals,
area lighting and for other indoor applications.